

1. Read and follow the installation requirements of the door manufacturers.
2. Cut the hole in the door to correspond to the order size of the vision frame. Assure that the opening is plumb and square.
3. Prepare the cutout if required, per the door manufacturers installation instructions.
4. Install caulking on both sides of LEXAN, see illustration.
5. Insert the corridor side frame in the cutout.
6. Insert LEXAN into frame, seating firmly, using setting blocks as needed.
7. Inserting 2 of the screws provided in the countersunk holes, carefully align the room side of the frame to the holes in the corridor side of the frame. Screw in enough to hold frame in place for alignment, then insert the other screws lightly. Tighten the screws alternately in a criss-cross pattern to avoid putting more pressure on one side than the other. Do not tighten to the point of deflecting the frame.

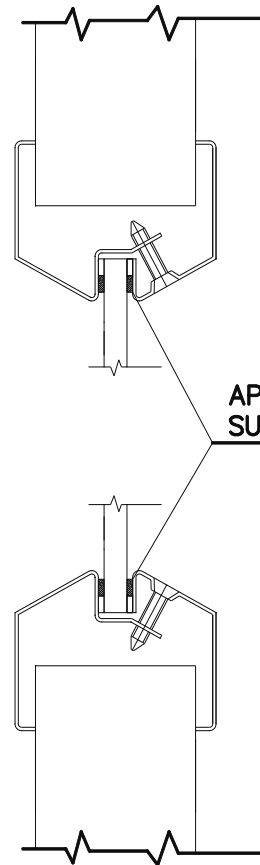

**APPLY SIKAFLEX-552 TO BOTH SIDES OF LEXAN,
SUPPLIED BY AIR LOUVERS**

VLF-EZ-HRC FRAME PROFILE



A DIVISION OF

www.activarcpg.com

Construction Products Group

INSTALLATION INSTRUCTIONS FOR VLF-EZ-HRC

HEADQUARTERS: 4450 WEST 78TH ST CIRCLE, BLOOMINGTON, MN 55435-5416 PH: 800-766-0660 FAX: 952-835-2218 EMAIL: SALES@AIRLOUVERS.COM WWW.ACTIVARCPG.COM
ACPG WEST COAST (MANUFACTURING): COMMERCE CA • ACPG WAREHOUSES: LANCASTER PA, ATLANTA GA, CHICAGO IL